

Head office  
18941 - 111 Avenue NW  
Edmonton, Alberta  
T5S 2X4  
Fax: 780-800-1927



[www.exploresurveys.com](http://www.exploresurveys.com)

Branch Office  
Box 1987, 5133-50 Ave  
St. Paul, Alberta  
T0A 3A0  
Fax: 780-800-1927

Friday, September 09, 2016

File No. X031716  
Subdivision File No. S-2016-12

County of St. Paul No. 19  
5015 49 Ave  
St. Paul, AB  
T0A 3A4

Attn: County Council

Re: Amendment to subdivision file S-2016-12  
In NE 18-58-10-W4M

We, Explore Surveys Inc are the agent for Mr. David Ostapovich (landowner) for the above noted subdivision file. We kindly request that council review the proposed tentative plan revision for approval.

Conditions of approval #3 and #4 relate to the relocation of the septic pumpout and the assurance of a minimum setback (50m) to the water well. The current location of the proposed subdivision and improvements would require the landowner to relocate both the pumpout and the water well resulting in approximately \$15000 in additional costs.

As an alternative to installing a new well, this revision would extend the subdivision West by 5.18m (17') being the width of land that is to be taken by the County as caveat for road widening listed under condition of approval #2. This will cause the subdivision area to increase above the maximum 20ac to 20.41ac, however should the County later claim this strip for road widening the area of the subdivision will decrease back to 20ac.

In summary, we ask that Council consider this option as an alternative to help reduce costs.

Please contact me should you have any questions.

Sincerely,

A handwritten signature in blue ink, appearing to read "Dave Samson", is written over a horizontal line.

Dave Samson  
Project Manager  
Office: (780) 645-3399  
Cell: (780) 227-1234  
[daves@exploresurveys.com](mailto:daves@exploresurveys.com)

encl.  
Revised Tentative Plan  
Conditional Approval Letter

# TENTATIVE PLAN

## SHOWING PROPOSED SUBDIVISION OF

### N.E.1/4 Sec.18 Twp.58 Rge.10 W.4Mer.

### COUNTY OF ST. PAUL NO. 19

**LEGEND:**

Proposed Parcel shown as: ..... ———

Proposed Pumpout location shown as: ..... P

Current Well location shown as: ..... W

(New well to be drilled by home owner)

Existing Approaches shown as: ..... —

PIPELINE RW PLAN 952 4026

PIPELINE RW PLAN 942 1578

N.E.1/4 SEC.18-58-10 W.4M.

**LOT 1**  
**BLOCK 1**  
AREA = 8.26 ha

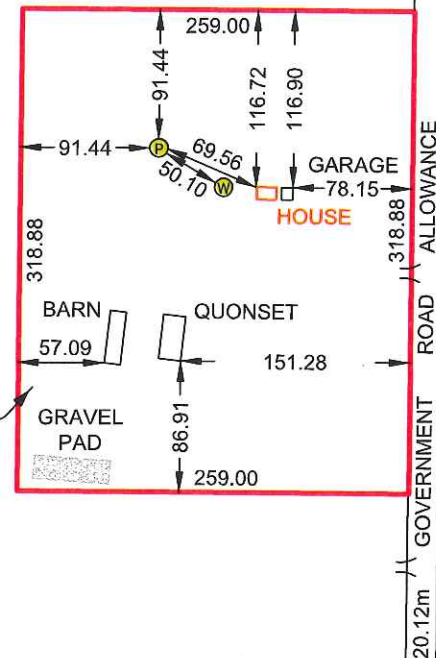

Distances are in metres and decimals thereof.

**EXPLORE**  
SURVEYS INC.

Plan Prepared by:  
Explore Surveys Inc.  
Edmonton, Alberta  
Toll Free 1-866-936-1805  
Fax No. 780-800-1927

40 20 0 50 100 200  
SCALE 1:5,000

REV. NO.	DESCRIPTION	DATE
1	PLAN ISSUED	MAY 16/16
2	PLAN UPDATE	JUNE 6/16
3	PLAN UPDATE	SEPT. 8/16

Job X031716

Rev. 3

SURVEYED BY: M.K.

CALC'D BY: A.M.

DRAWN BY: A.M.



# TENTATIVE PLAN

## SHOWING PROPOSED SUBDIVISION OF N.E.1/4 Sec.18 Twp.58 Rge.10 W.4Mer. COUNTY OF ST. PAUL NO. 19



Imagery: ©2015 Abacus Datagraphics Ltd., all rights reserved.

Date of Photography: October 2012

Distances are in metres and decimals thereof.

**EXPLORE**  
SURVEYS INC.

Plan Prepared by:  
Explore Surveys Inc.  
Edmonton, Alberta  
Toll Free 1-866-936-1805  
Fax No. 780-800-1927



REV. NO.	DESCRIPTION	DATE
0	PLAN ISSUED	MAY 16/16
2	PLAN UPDATE	JUNE 6/16
3	PLAN UPDATE	SEPT. 8/16

Job X031716

Rev. 3

SURVEYED BY: J.A.

CALC'D BY: A.M.

DRAWN BY: A.M.