

County of St. Paul
5105 49th Ave
St. Paul, AB T0A 3A4

March 29, 2016

Dear County of St. Paul,

The Lakeland Centre for Fetal Alcohol Spectrum Disorder (LCFASD) is seeking your support of \$5000 to build a unique cabin to offer summer and winter camps to children with FASD. The facility is located 15km east of the City of Cold Lake in the French Bay Provincial Park area on Cold Lake, next to the Kinosoo Ski Hill.

The special needs of children with FASD can often make it impossible for them to participate in regular camp programs. They are often sent home for disruptive behavior. On other occasions, the emotional challenge is too great. A fear of failure may push them over the edge, into despondency. The Lakeland Centre for Fetal Alcohol Spectrum Disorder (LCFASD) is looking to build a facility that can provide a fun and safe environment where children with FASD can be themselves and have a positive camp experience without the fear of rejection. The camp teaches leadership, socialization skills, and respect for the environment; provide trips that are educational and fun; as well as offering cultural experiences. These one week camps also provide a respite for the parents or care givers during the child's stay.

One young boy who attended the camp had such severe behavior that he was unable to attend school. He was being raised by an elderly grandmother who struggled with how best to manage him. We were able to provide him with a week of camp that gave his grandmother a break and gave him a week of confidence and control. In the following year, the school was able to design his entire program so that he was learning how to be a camp leader. He read camp songs, did camp crafts, learned to swim and assisted younger children in gym class. He still struggles with regular school but has been able to attend an off campus junior and senior high school. Today at 17 he has never been in trouble with the law. He has returned to the summer camp as a helper. This positive experience is not uncommon for the kids attending this specialized camp.

After 10 years of operating this camp in another rental location we will be able to provide many more with positive life experiences and more often. The LCFASD can only achieve its goals with the assistance of generous donations from members of our community. The original project is about 1 million dollars but in today's economic situation we have scaled back the project into manageable phases over several years. This first phase will see us build a modest but functional cabin for staff and campers. The value of phase one will cost \$350,000, with some funds raised in previous events and a small mortgage from the bank, we believe that with

community donations we can achieve this goal. Your donation will be used to cover the costs of bunk beds, appliances, dishes, furniture, utilities and other necessary items to operate a camp in 2016.

The LCFASD main office is located in the heart of Cold Lake south, with three additional satellite offices in Bonnyville, St. Paul and Lac La Biche.

Each donation will be recognized in local media and will have a special place of recognition within the cabin and at the LCFASD main office.

Please feel free to contact me with any questions, or **for a presentation** at 780.594.9905 or amcfarlane@lcfasd.com

Sincerely,



Audrey McFarlane
Executive Director

**Attached: Drawings of the phase 1
LCFASD service brochure
Camp Post card**

Additional Information:

Legal Name: Lakeland FASD Society

Charitable number: 886213602RR0001

Number of children that have attended camp since operations began: 120

Number of children that will have opportunity to attend camp in 2016: 60

University and college students from the Lakeland area are hired each year to operate the camp.

Number of individuals/families served each year by LCFASD: 400

NOTE:
TOTAL ROOF VENTILATION REQUIRED
3.42ft² (564.48in²)
TOTAL REQUIRED AT TOP OF ROOF
0.98ft² (141.12in²)

CONTINUOUS RIDGE VENT

METAL ROOFING

2X6 FASCIA BOARD
w/PRE-FIN ALUM. FASCIA

ALUMINUM EAVESTROUGH
& DOWNSPOUTS

VENTED ALUM. SOFFIT

2' - 0"

6 5/8" x 7 5/8" LOG TIMBER
w/CHINKING

PARGING AS REQUIRED

SLOPE GRADE AS REQ'D

ADJUST STEPS TO SUIT GRADE



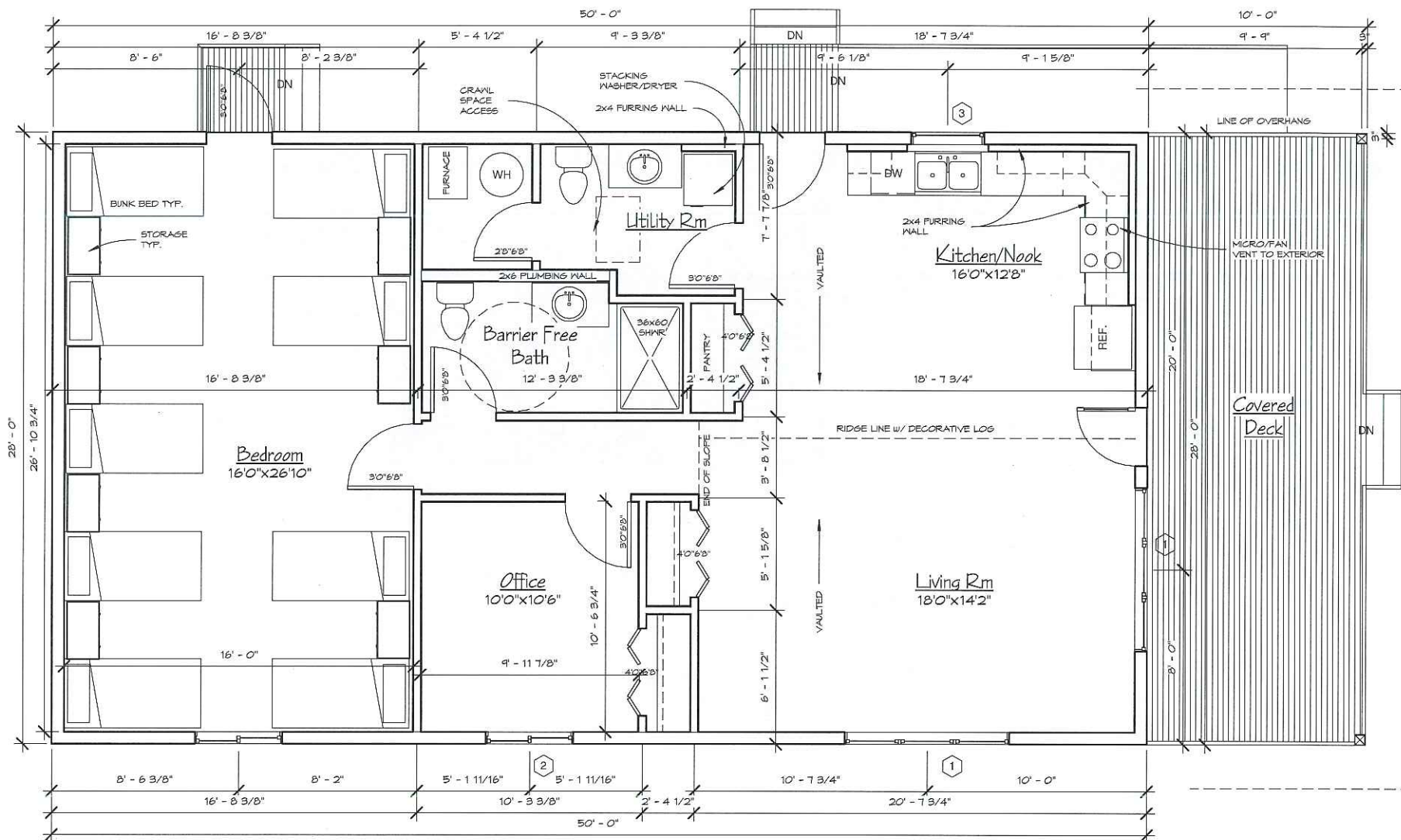

AREA: 1,400sq.ft.